

# Leg bag with Lever Tap

## INSTRUCTIONS FOR USE

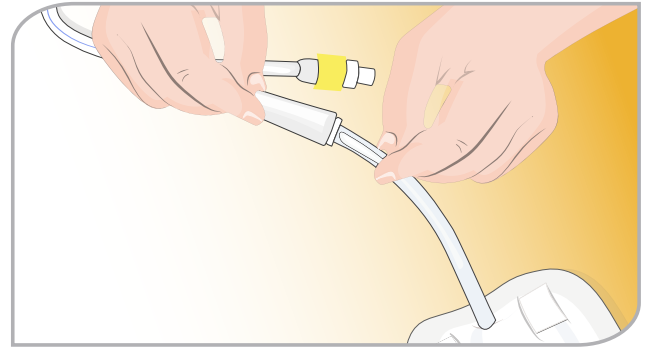

**1.** Perform hand hygiene.



**2.** To disconnect or change your drainage bag, pinch the catheter above the drainage bag to stop the flow of urine and disconnect using a twisting motion.

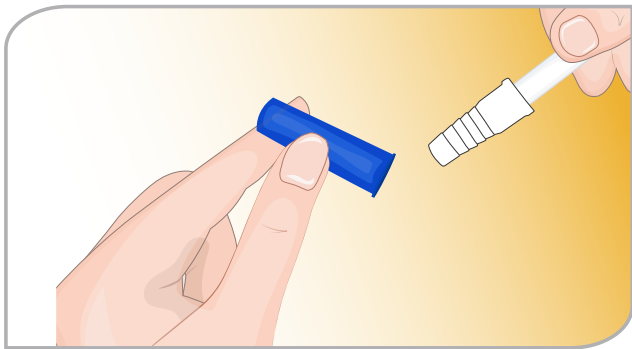

**3.** Remove blue protective cap from stepped connector on the inlet drainage tube and using aseptic technique, connect directly into the funnel end of the foley catheter. Ensure the connection is secure.

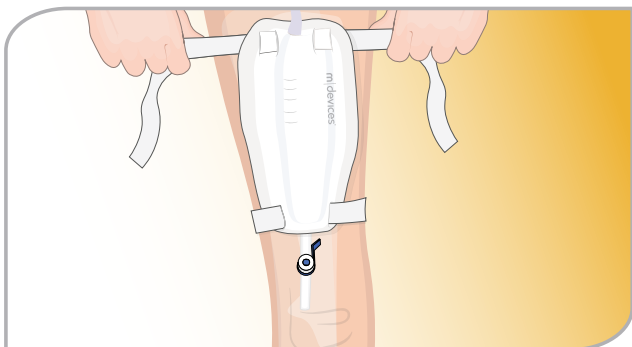
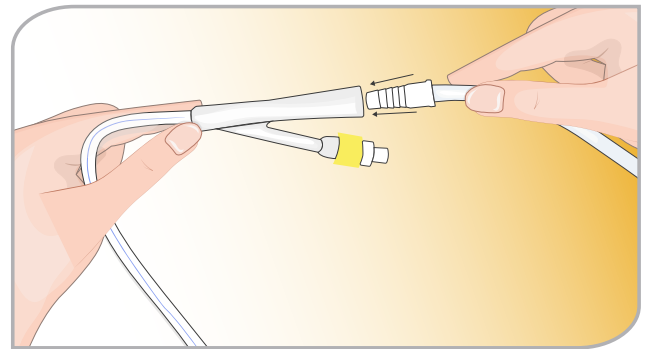

**4.** Using the silicone lined straps, apply the Leg Bag to the desired thigh by wrapping the two straps on the bag around the thigh at desired position. Secure the silicone lined straps by pressing together the corresponding side of the fabric fastener on each strap end. Fabric must be firmly pressed together to obtain a secure fixation.



# Leg bag with Lever Tap

## INSTRUCTIONS FOR USE

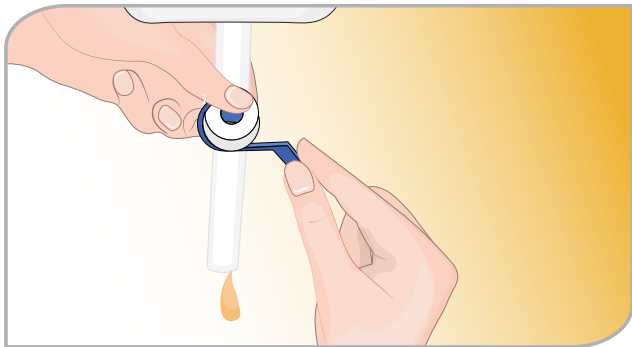

- 5.** To empty the bag (the lever tap will be in the closed position when removed from packaging and moves in both directions by 90 degrees), push the blue lever firmly down towards the outlet tube, this will open the tap and urine will flow out.

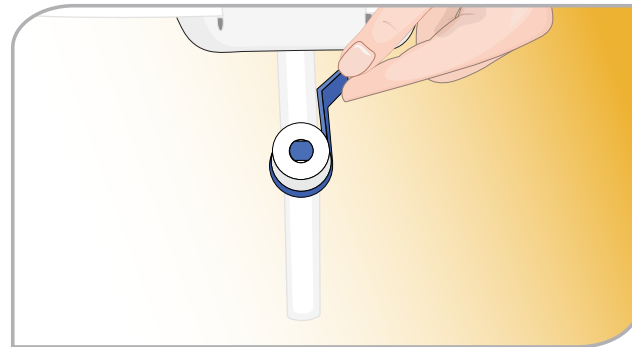

- 6.** Once empty, close the tap by pushing the lever firmly up towards the Leg Bag until closed.



## CAUTION

- Single use.
- DO NOT re-sterilise.
- DO NOT store at extreme temperatures and humidity, avoid direct sunlight. Handle with care.
- STERILE (EO), DO NOT use if the package or product has been damaged or contaminated.

Always read the label and follow the Instructions for Use. Our guidance is not intended to substitute professional medical advice and does not constitute health advice. If you have concerns or questions regarding the use of this product, seek advice from a qualified healthcare professional.



m|devices®

(02)8718 2800  
info@mdevices.com.au  
mdevices.com.au