

UR060000 & UR060001

Urinary Catheter Securement Device

INSTRUCTION FOR USE

DESCRIPTION

m|devices Urinary Catheter Securement Device is designed to secure an indwelling or suprapubic urinary catheter in place, whilst ensuring patient comfort is maintained. The adhesive dressing has a water-resistant backing that is low irritant and soft on the skin. Available in a standard and large size. The standard size suits all 2-Way Foley Catheters where as the large size is designed for use with a 3-Way Foley Catheter to cater for the additional irrigation lumen.

FOR USE BY A QUALIFIED CLINICIAN. THE BELOW IS ONLY A SUGGESTION AND FACILITY PROTOCOL MUST BE FOLLOWED FOR ALL CLINICAL PROCEDURES WHERE THIS PRODUCT IS USED.

CAUTION

DO NOT use if the packaging or product has been damaged or contaminated
DO NOT store at extreme temperatures and humidity. Avoid direct sunlight.
Single patient use

STEPS:

1. Prepare the skin by cleaning the desired location for the Securement Device using an alcohol wipe. Allow to dry.
2. Ensure that the patient's leg is extended and that the catheter has at a minimum, one inch of tubing slack between the urinary meatus and the securement site before applying the dressing to the location site.
3. Using the two tabs of the paper backing, peel paper backing off to expose the adhesive dressing.
4. Apply Securement Device to the desired location without any wrinkling on the dressing to ensure a smooth even contact with the skin.
5. Peel off the white backing on the adhesive strip. Holding the bifurcation of the catheter (the point where the two channels meet; the funnel and the balloon valve), place the funnel channel onto the adhesive strip firmly, close to the bifurcation. Once in place, this adhesive strip prevents the catheter from sliding out of position.

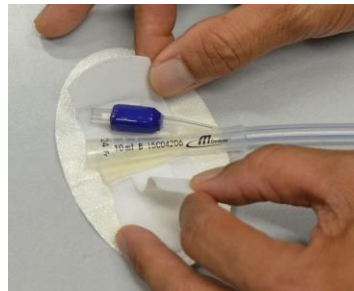

6. Whilst holding the channel for the balloon valve out of the way, fold the larger of the two tabs over the funnel channel and feed the smaller tab through the larger tab opening (crossing over each other) and secure the tabs to the material. The tabs can be re-lifted numerous times if required, until the catheter is firmly secured in the desired position.

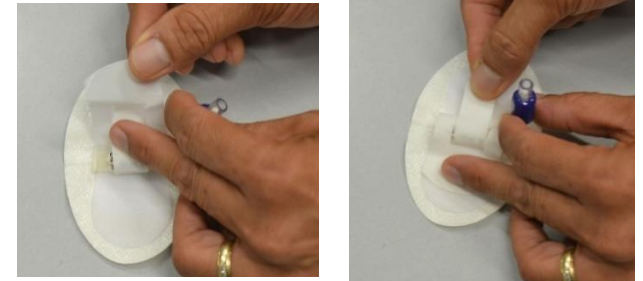

7. To remove the urinary catheter securement device, gently lift one edge of the dressing and slowly peel away from the skin.

PRECAUTIONS:

- For optimum results, do not immerse the Urinary Catheter Securement Device in water.
- Ensure dressing component of the Securement Device is applied evenly to skin without creases.

m|devices
27 Llewellyn Avenue
Villawood NSW 2163 Australia
T +61(0)2 8718 2800
F +61(0)2 8718 2801
mdevices.com.au

m|devices®